

Notes: \*SEATING CAPACITY IS 120

\*SEATING PLATFORMS ARE WENGER UNITS.

\*24 TOTAL WENGER PLATFORMS NEEDED

\*ALL SEATING TIERS SHOULD RECEIVE A TOE RAIL.

\*CHAIR RAIL/GUARD RAILS USED ON ALL TOP-LEVEL SEATING TIERS.

\*INDICATED COLUMNS ARE PAINTED; SEE PAINT ELEVATION.

\*WINDOWS ARE PAINTED; SEE PAINT ELEVATION.

\*INTERIOR OF THE ELEVATORS ARE PAINTED; SEE PAINT ELEVATION.

\*PLEASE SET ASIDE 4 WENGER DECKS FOR CONTROL BOOTH.

**JOEY SARNO**

740 S. NEGLEY AVE. #202  
PITTSBURGH, PA 15232  
252.286.7003  
JOSEPHMSARNO@GMAIL.COM  
JOEYSARNO.COM

CARNEGIE MELLON UNIVERSITY SCHOOL OF DRAMA PRESENTS  
**THE GLASS MENAGERIE**

BY: TENNESSEE WILLIAMS

DIRECTED BY: MICHELLE SUTHERLAND

**PRODUCTION TEAM**

SCENIC DESIGNER	JOEY SARNO
ASSISTANT SCENIC DESIGNER	PAM LEE
LIGHTING DESIGN	SONG ZHANG
COSTUME DESIGN	DELISLE MERRILL
MEDIA DESIGN	JORDAN HARRISON
PROJECT MANAGER	ANDREW O'KEEFE
JOB LEAD	DAVID FELDSBERG
PRODUCTION MANAGER	CHRISTINA BENVENU
CHARGE ARTIST	BETH ZAMBORSKY

The designer is responsible for the visual aspects of the production only, and the specification of the designer's designs relate solely to the appearance of the design and not to matters of safety. The designer agrees to make prompt correcting alterations to any specifications found to be incompatible with proper safety precautions

201 N. BRADDOCK AVE.

DATE: 03-17-2014

SCALE: 0'-1/4" = 1'-0"

REVISION NO: 3

DRAWN BY: JMS

**GROUND PLAN/SECTION**

PLATE NO.

**1**

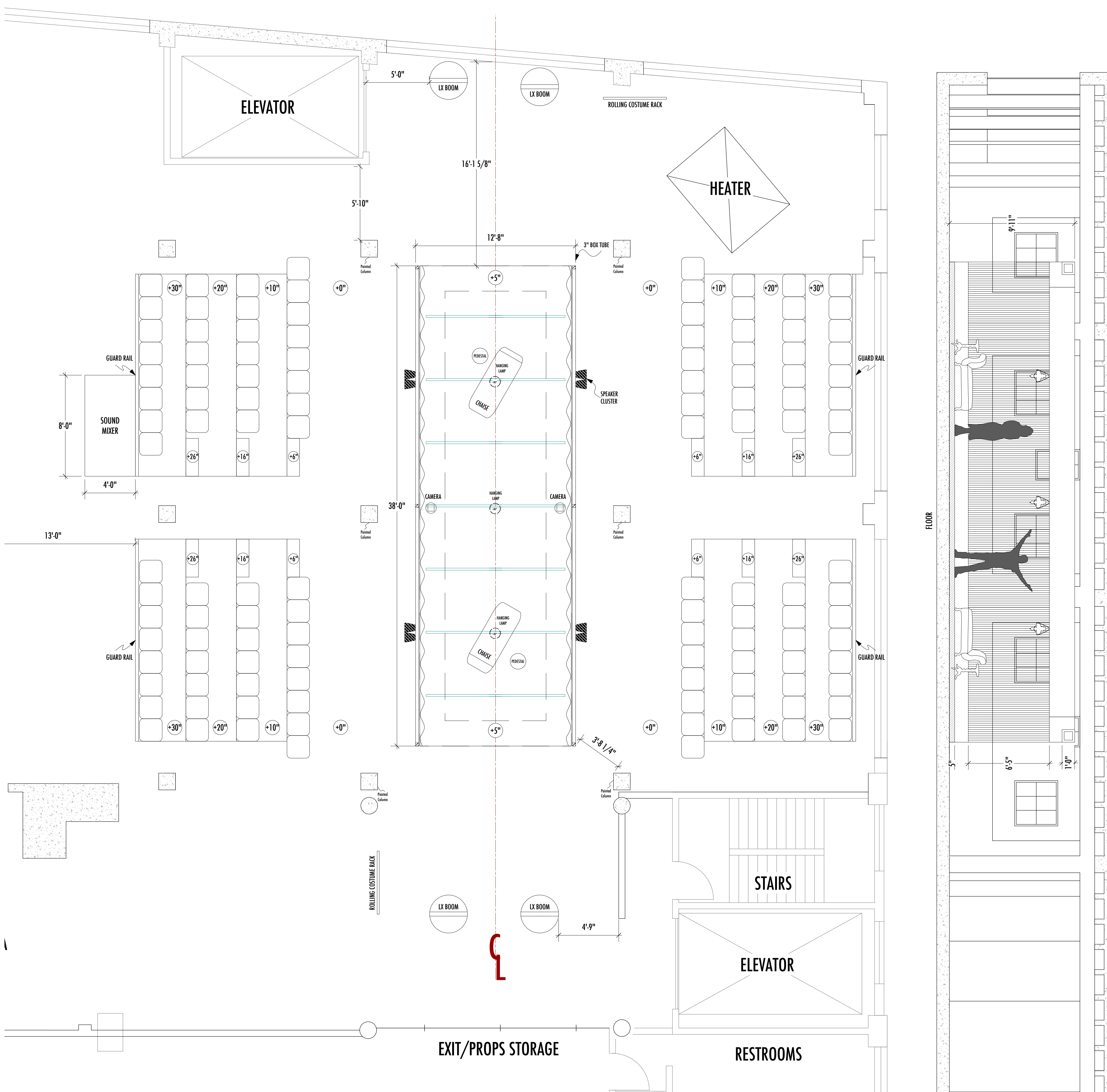

**Notes:** \*PARAPET SITS ON THE OUTSIDE OF THE RUNWAY.  
 \*SPEAKER CLUSTERS ARE MOUNTED TO THE HEADER.  
 \*TOP OF THE HEADER IS NOT FACED WITH MASONITE.  
 \*STRING CURTAIN SHOULD BE TRIMMED TO THE TOP OF THE PARAPET AFTER INSTALL.  
 \*LET'S DISCUSS THE LED TROUGH SPECIFICS FOR THE HEADER UNIT.

**Carnegie Mellon University**  
**Drama**

**JOEY SARNO**  
 740 S. NEGLEY AVE. #202  
 PITTSBURGH, PA 15232  
 252.286.7003  
 JOSEPHMSARNO@GMAIL.COM  
 JOEYSARNO.COM

CARNEGIE MELLON UNIVERSITY SCHOOL OF DRAMA PRESENTS  
**THE GLASS MENAGERIE**  
 BY: TENNESSEE WILLIAMS  
 DIRECTED BY: MICHELLE SUTHERLAND

**PRODUCTION TEAM**

SCENIC DESIGNER  
**JOEY SARNO**  
 ASSISTANT SCENIC DESIGNER  
**PAM LEE**  
 LIGHTING DESIGN  
**SONG ZHANG**  
 COSTUME DESIGN  
**DELISLE MERRILL**  
 MEDIA DESIGN  
**JORDAN HARRISON**  
 PROJECT MANAGER  
**ANDREW O'KEEFE**  
 JOB LEAD  
**DAVID FELDSBERG**  
 PRODUCTION MANAGER  
**CHRISTINA BENVENU**  
 CHARGE ARTIST  
**BETH ZAMBORSKY**

The designer is responsible for the visual aspects of the production only, and the specification of the designer's designs relate solely to the appearance of the design and not to matters of safety. The designer agrees to make prompt correcting alterations to any specifications found to be incompatible with proper safety precautions

201 N. BRADDOCK AVE.

DATE: 03-17-2014

SCALE: VARIOUS

REVISION NO: 3

DRAWN BY: JMS

**ELEVATIONS**

PLATE NO.

**2**  
 OF 2

